

PLAN

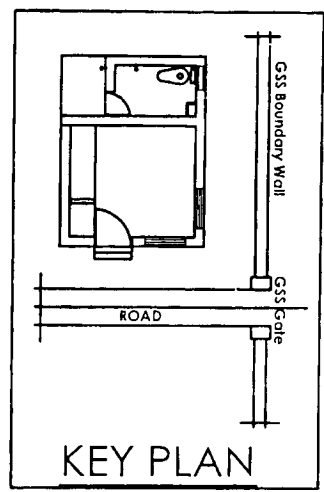

KEY PLAN

Note :-

1. All DIMENSIONS ARE IN MILLIMETERS.
2. CEILING HEIGHT = 2700 mm.
3. PARAPET HEIGHT = 300 mm.
4. Lintel Height with Chajja = 2000 mm
5. PLINTH HEIGHT = 300 to 450 mm above road level.
6. FLOORING = Kota stone/As approved by S.E. (C-Tr).
7. Plinth Area = 14.40 Sqm.
8. W.C.:- Orrisa Pan.

Joinery Schedule

Type	Details	Size in mm
D1	Door Wooden (Flush)	900 x 2000
D2	Door Wooden (Flush)	700 x 2000
W	Window (Steel)	900 x 1200
V	Ventilator (Steel)	450 x 450
# AL	Almira (Open)	900 x 2000

RAJASTHAN RAJYA VIDYUT PRASARAN NIPUN
SUPERINTENDING ENGINEER
CIVIL (QC & DESIGN, JAIPUR)

PROPOSED DRAWING FOR GUARD HUT
AT VARIOUS GRID SUB STATIONS

Date 15/10/16	Drawing No. R.K.16	Proposed By ANOOP GOYAL SEN CIVIL DESIGN	Approved By R.K. CHHABRA S.E. (QC & DESIGN)
------------------	-----------------------	--	---