

DRAWING OF 9 MTR LONG P.C.C. POLE WITH WORKING LOAD 400 KG

TN-1534

2 HOLES DIA 16

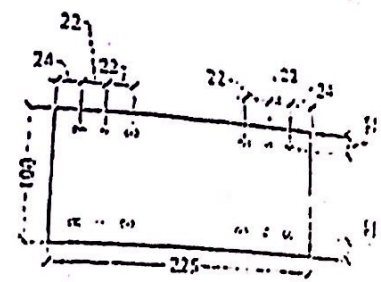
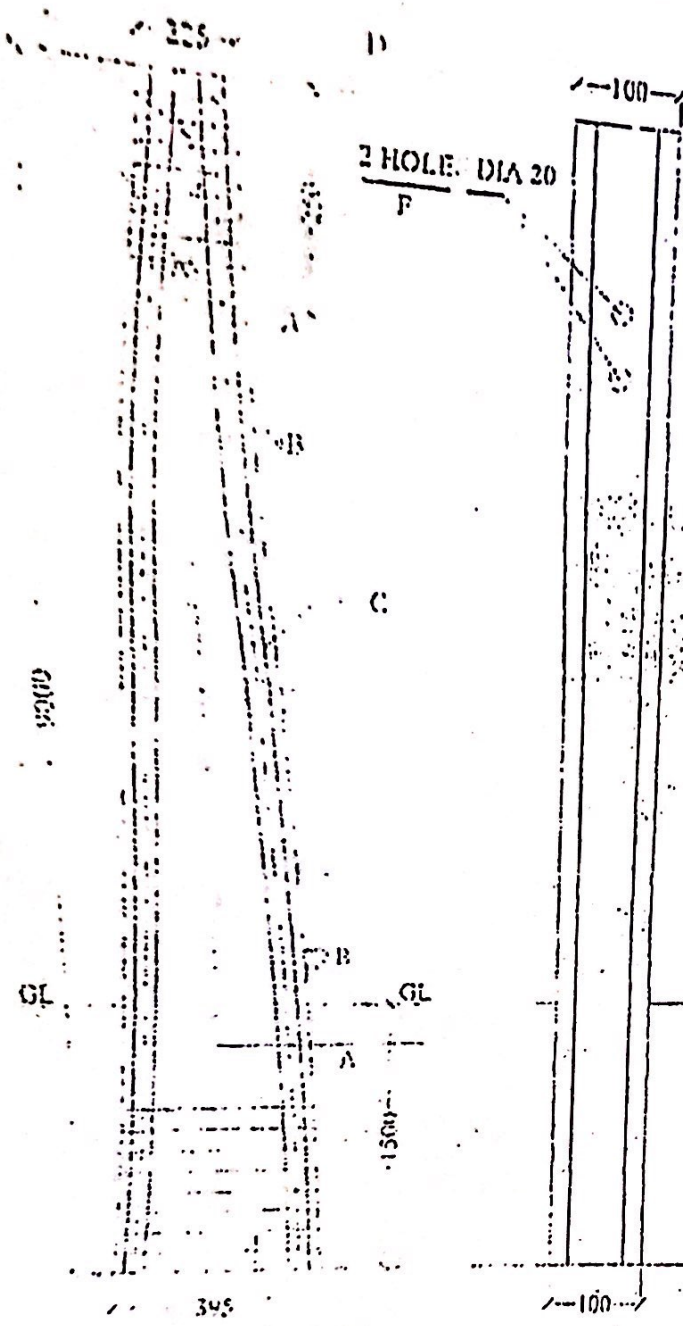

VIEW FROM TOP

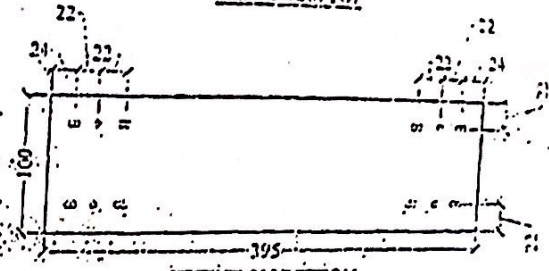

VIEW FROM BOTTOM

○ DENOTES TENSIONED WIRE

TECHNICAL DATA	
FACTOR OF SAFTY	2.0
CONCRETE GRAD	M-40
DIA OF PRESTRESSING WIRE	4.504
ULTIMATE TENSILE STRENGTH	1750 KG/CM ²
NO. OF TENSIONED WIRE	20
CONCRETE QUANTITY PER POLE	0.277 M ³
STEEL QUANTITY PER POLE	18 KG
WEIGHT OF POLE [APPROX]	675 KG
CONCRETE COVER	20MM - 25MM

- A. 51 WIRE OF 4 MM DIA WITH A PROJECTION OF 100 MM AT 250MM FROM TOP & 150 MM BELOW GROUND LEVEL
 - B. 2 NOS. OF EYE HOOK OF 12 MM DIA M.S. ROUND HAVING INTERNAL DIA OF 40MM AT 225 M FROM TOP & 1.5 M FROM BOTTOM.
 - C. 20 NOS. OF 4 MM DIA H.T. WIRE TENSIONED.
 - D. 3 NOS. OF 4 MM DIA H.T. WIRE OR 4 NOS. OF 6 MM DIA M.S. ROUND RINGS ON BOTH ENDS WITH MINIMUM INTERSPACING OF 70 MM & 30 MM RESPECTIVELY.
 - E. 2 HOLES OF 16 MM DIA AT 60 MM & 160 MM FROM TOP ON LONGITUDINAL FACE OF POLE (BROAD FACE).
 - F. 2 HOLES OF 20 MM DIA AT 270 MM & 320 MM FROM TOP ON TRANSVERSU FACE OF POLE (NARROW FACE).
- ALL MARKING EMBOSSED ON TRANSVERSE FACE OF POLE.

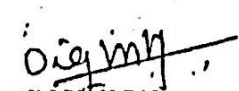
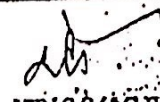
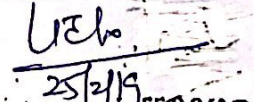

 A/E (M&C-V) XEN (M&C-III) 25/2/19 (S/P M&C)
 JODIPUR VIDYUT VITRAN NIGAM LTD., JODIPUR

ALL DIM. ARE IN MM
DRAWING NOT TO SCALE